

Stroke		
	250	400
A	8	10
B	3×190	4×190
C	290	440
D	350	530
E	767	967
	UA 5 DNL-23	UA 5 DNL-43

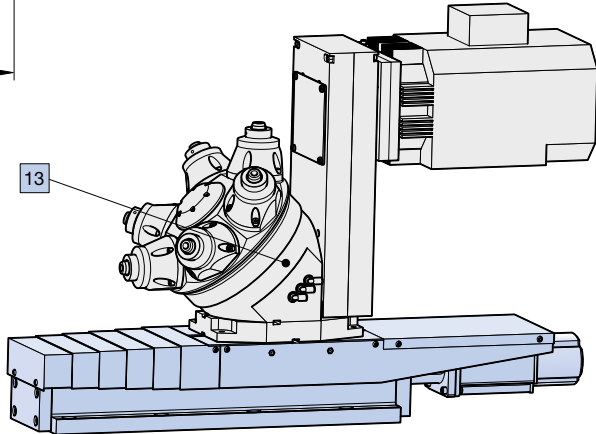
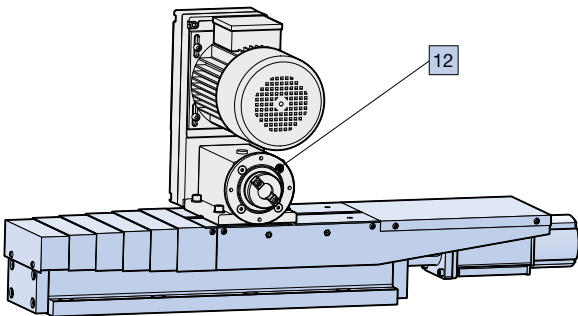
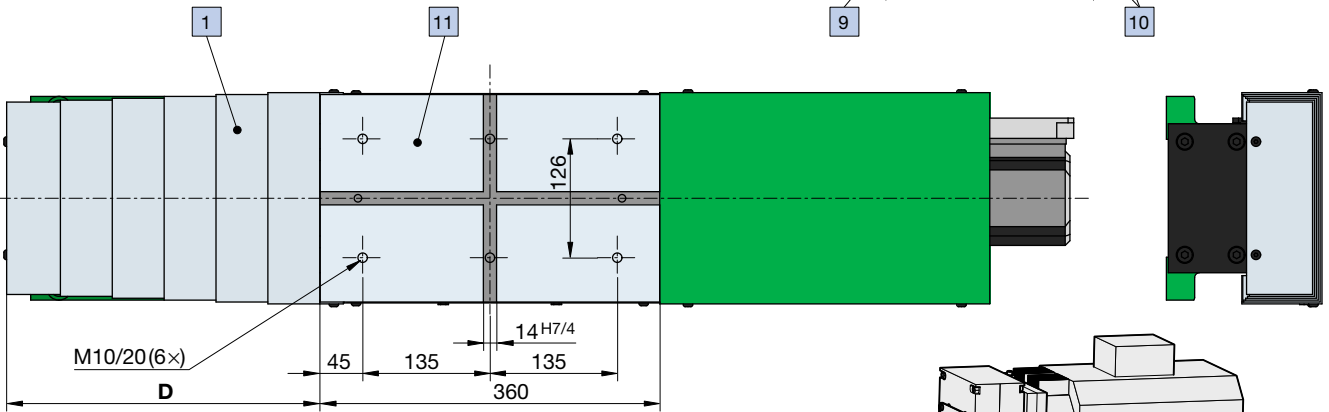
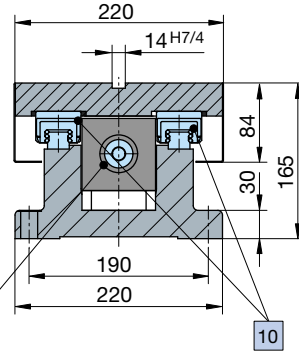
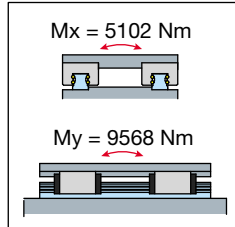

- Slide units **UA 5 DNL** are high-performance, heavy-duty feed components. Stroke execution: 250 and 400 mm
- Movement using 4 double preloaded ball slides and ball spindle.
- Suitable for the **UA 5 DNL** are machining unit **MAX 45 B** and revolving head **ETR 36**, as illustrated in section 3, and **MAX 30 B** for 90° mounting.
- **UA 5 DNL** base is made of cast iron, installation and lineup with M16 screws, without keys.
- **Option:** Other motors than MKD 071, cam rail switch box.
- **Order reference:**
UA 5 DNL 23: CNC slide unit, stroke 250 mm
UA 5 DNL 43: CNC slide unit, stroke 400 mm

Total stroke	250 / 400 mm
Ball screw pitch	5 mm, dia. 25 mm
Positioning accuracy	± 0.01 mm
Thrust in both directions	7500 N
Option: Parvex Motor	HD 630 ET / 9 Nm
Color	RAL 6018
Weight, stroke 400	145 kg

1 Telescopic way cover 20/10
3 Grease nipples located on both sides
5 Slide in steel, for unit adaption
7 Standard motor: Indramat MKD 071
9 Ball screw class T5, nut preloaded
11 For direct mounting of MAX 30 B and MAX 45 B
13 Revolving head ETR 36, section 3
Option: centralized lubrication, section 8